



Refill Instructions

Resin exhaustion is indicated by the colour change of the resin. The clear part of the Rinse Pimp will change from blue to orange.

Step 1

Remove the top tap adapter complete with internal screen, [fig 1] and exchange for the tap adapter (provided) that does not contain a screen [fig 2]



Step 2

Connect a hose to the bottom of the Rinse Pimp [fig 3]. Next connect the short hose provided to the top of the Rinse Pimp [fig 4] and place the other end of the hose into a bucket.



Step 3

Turn on the tap slowly and wash the resin into the bucket. Wait for the water to change from straw coloured [fig 5] to clear (resin free), then turn off the tap [fig 6]

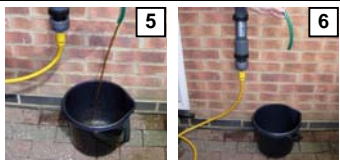

Step 4

Remove the hose from the top of the Rinse Pimp. Next place the bucket underneath the Rinse Pimp. Then drain remaining water from the Rinse Pimp into the bucket by removing the bottom hose [fig 7 + 8]

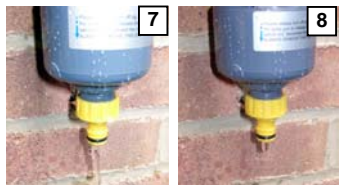

Step 5

Remove the top tap adapter and place the funnel provided into the top of the Rinse Pimp. Next pour the blue colour change resin into the funnel [fig 9] and add a little water to aid the resin flow. After allowing the water to drain pour in the brown resin and again add a little water to aid resin flow. Finally replace the top tap adapter complete with internal screen [as shown in fig 1]. Your Rinse Pimp is now ready to be used again.

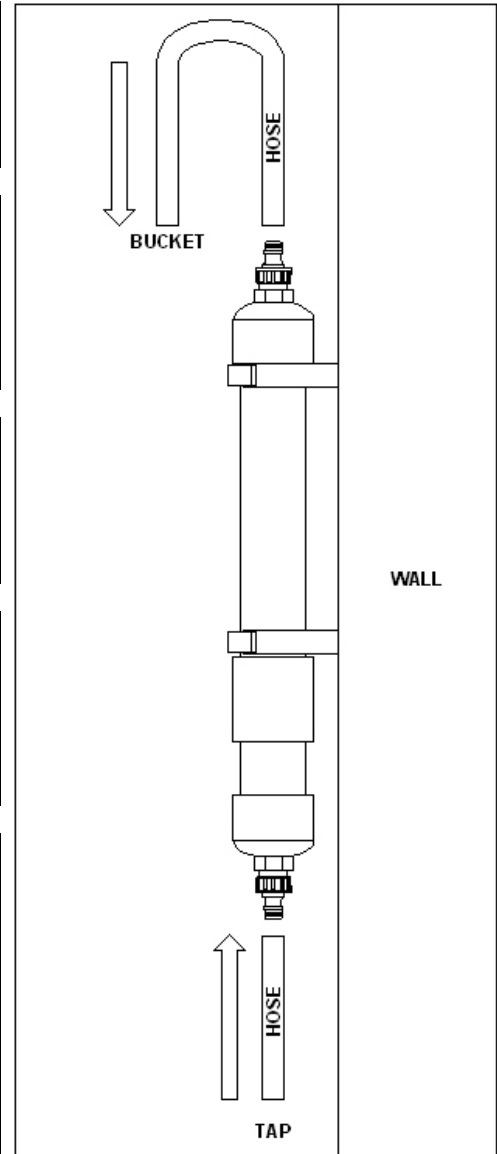
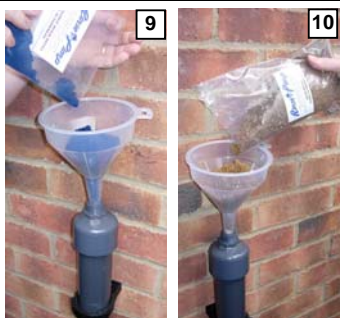

It is important to check the resin in the Rinse Pimp regularly – once it is exhausted and has changed colour from blue to orange it will no longer remove the impurities from the water and will be ineffective.

Colour Change Resin



Exhausted Colour Change Resin

